

CoHABITAT PROPOSAL

Promote innovation
proposal introduce ideas of co-habitation as another living option & takes into consideration of additional housing units being added over 5 years (up to 5 qty, or as allowed).

Allow for community to be created by action
--thru working together, thru sharing space, + thru evolving together.

Create incremental milestones for residents by gaining understanding of inhabitants needs necessary to facilitate priorities and objectives.

Over the time-frame of 5 years, increased density to encourage community sharing thereby increasing affordability & sharing.

Provide for aging in place and strategize for the future.

MAINTAIN with a flexible approach; work to determine when to pivot or simply move forward to the next level steppingstone.

DEVELOP STRATEGIES to facilitate, research/observe who the housing is serving & how best to serve themselves and others.

CREATE awareness to observe our natural environment & how best to serve it and living things that inhabit it; define what actions will be taken.

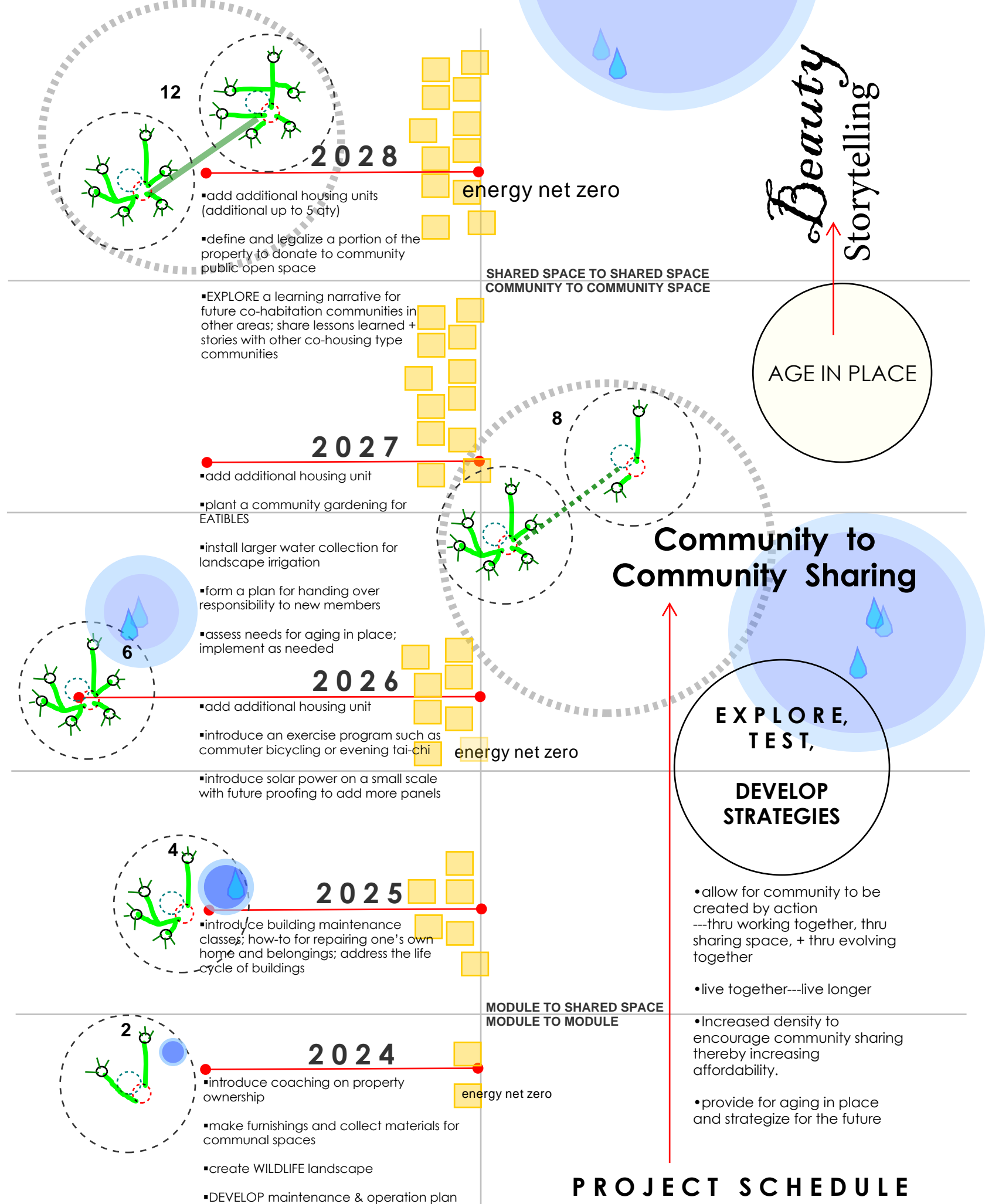

CoHABITAT PROPOSAL

what we each learned, we learned from each other.

We want to use the sharing economy as the model to rethink afford-ability and extend the traditional family structure into understand shared spaces.

affordable housing should have pathways.

integration can be created with the greater community and have open opportunities for upward mobility.

we cannot become successful in isolation.

We coexist in an environment in which one automatically influences each other. We count on each other from day to day---this becomes our bigger community.

We grow together and learn together.

We carry the responsibility to communicate and guide. Abilities and skills can be shared and explored. This begins the process of creating a social ecosystem that evolves.

As with all life's struggles, life's rewards take work.

This project assumes iteration of design through living over at least 2-5 years. It takes the day-to-day activities & working together to develop a lasting community.

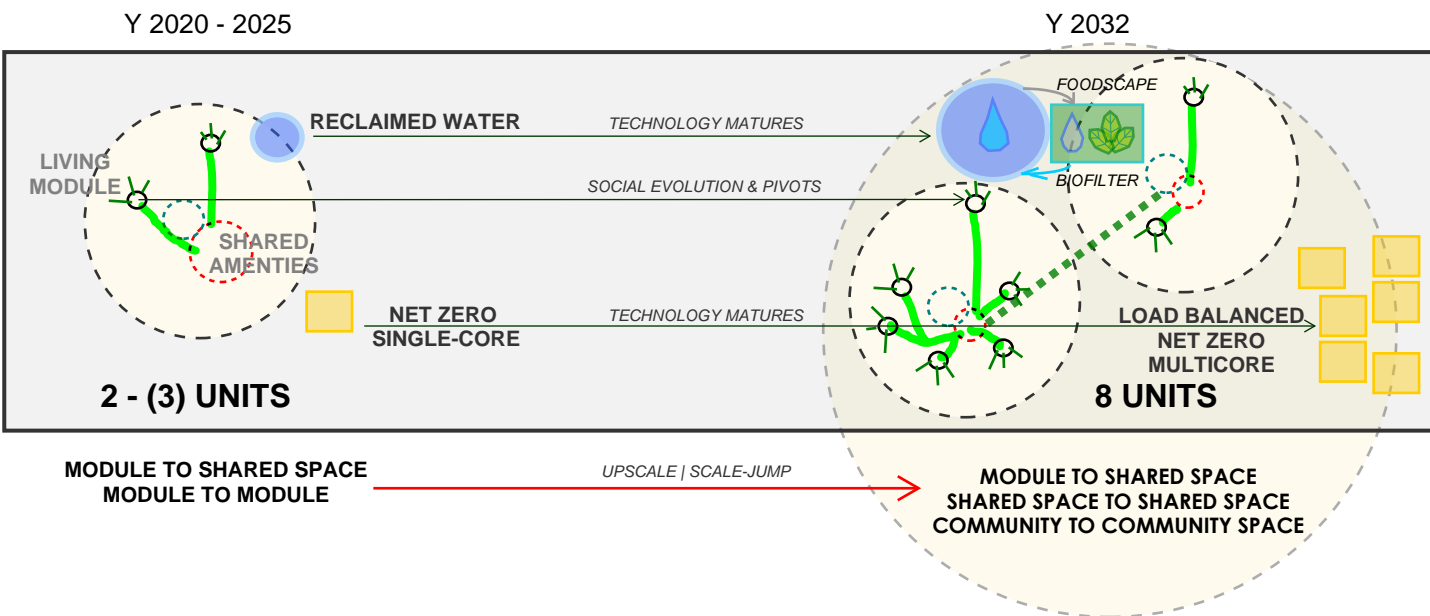

START:

- TEST with one unit; build over time to create a total of (5) living units and communal shared spaces.
- Achieve cost saving by using modular prefabricated units for private living & bedroom spaces.
- Limit kitchen and bath facilities to remove costs.
- Work with local planning to maintain a viable district zoning option.
- RESTORE what gets depleted.

PROGRAM + APPROACH

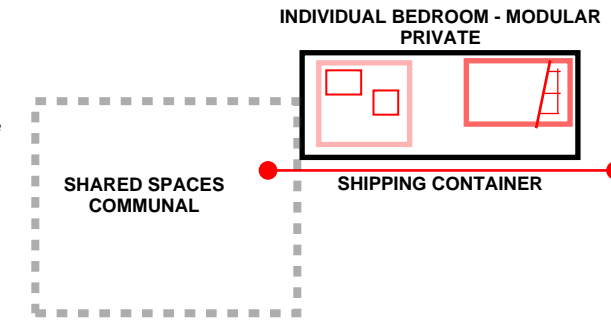

- EXPLORE means to facilitate and moderate public engagement.
- gain understanding of user needs necessary to facilitate priorities and objectives.
- introduce ideas of co-habitation as another living option.

PIVOT:

- MAINTAIN with a flexible approach; work to determine when to pivot or simply move forward to the next level stepping stone.
- DEVELOP STRATEGIES to facilitate, research/observe who the housing is serving & how best to serve themselves and others.
- CREATE awareness to observe our natural environment & how best to serve it and living things that inhabit it; define what actions will be taken.
- TEST process to determine when to keep working, and when to wait before starting again.
- collect data + results.
- SET with: mini goals.
- IMPLEMENT with: mini structures.

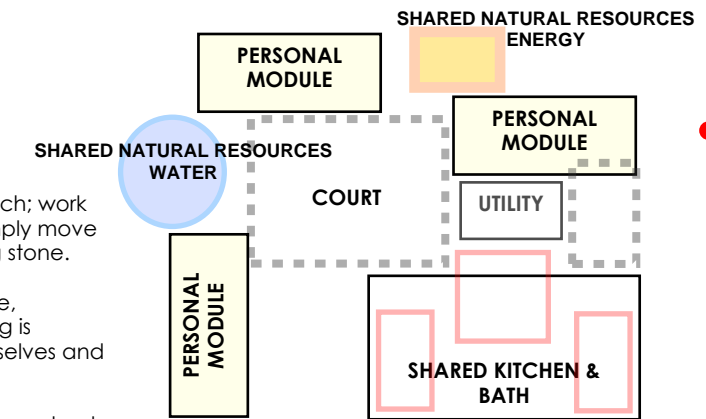

COMMUNAL + COMMITMENT

- TEST + EXPLORE + DEVELOP STRATEGIES
- EXPLORE incremental and increased communal facilities
- EXPLORE incremental shared resources of ENERGY and WATER
- TEST timespan over 5 years

ACHIEVE + OVERCOME BARRIERS (QUESTIONS/CONCERNS)

- DEVELOP STRATEGIES: FOR LONGEVITY
- Financial stability like sustainability---takes time & patience; takes work.
 - Instead of a rush of instant gratification why not create a community with a strong desire to evolve with a solid foundation of resiliency? This would require re-defining the time lines.
 - create incremental milestones for residents.
 - EXPLORE how we build a language that grows together.

EXPLORE:

- #### DIVERSITY
- bring open minds & inclusivity.
 - bring individual aspiration.
 - integrate and build trust.
 - build mobility and empowerment.
 - create economically sustainable housing option with the ability for the residents to contribute in different ways.
 - EXPLORE place for making and explore options for helping others make THEIR space.